

### BSP/UNF Nipel Adapters - BSP/UNF

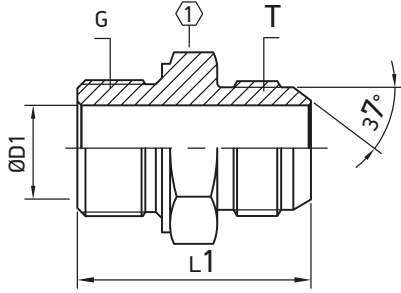

Kod Part Number	Diş Ölçüsü Thread		Boyut Ölçüleri (mm) Dimensions in (mm)			
ID No	G	T	ØD1	L1	①	PN Bar
HR330-2-4S	G1/8"-28	7/16"-20	4	29	14	420
HR330-4-4S	G1/4"-19	7/16"-20	4	34	19	420
HR330-4-5S	G1/4"-19	1/2"-20	6	34	19	420
HR330-4-6S	G1/4"-19	9/16"-18	6	34	19	420
HR330-4-7S	G1/4"-19	5/8"-18	6	35	19	420
HR330-6-6S	G3/8"-19	9/16"-18	7.5	35	22	420
HR330-6-7S	G3/8"-19	5/8"-18	7	36	22	420
HR330-6-8S	G3/8"-19	3/4"-16	9	38.5	22	420
HR330-8-6S	G1/2"-14	9/16"-18	7.5	38	27	420
HR330-8-7S	G1/2"-14	5/8"-16	8	38	27	420
HR330-8-8S	G1/2"-14	3/4"-16	9.5	41	27	420
HR330-8-10S	G1/2"-14	7/8"-14	11.5	43	27	350
HR330-8-12S	G1/2"-14	1"1/16-12	12	49	27	350
HR330-12-8S	G3/4"-14	3/4"-16	10	45	32	350
HR330-12-10S	G3/4"-14	7/8"-14	12	48	32	350
HR330-12-12S	G3/4"-14	1"1/16-12	16	51	32	350
HR330-12-16S	G3/4"-14	1"5/16-12	18	53	6	315
HR330-16-12S	G1"-11	1"1/16-12	16	54	41	315
HR330-16-16S	G1"-11	1"5/16-12	21	55	41	315
HR330-20-16S	G1"1/4-11	1"5/16-12	28	59	50	315
HR330-20-20S	G1"1/4-11	1"5/8-12	27	60	50	315
HR330-24-20S	G1"1/2-11	1"5/8-12	27	64	55	315
HR330-24-24S	G1"1/2-11	1"7/8-12	32	67	55	315
HR330-32-32S	G2"-11	2"1/2-12	44	79	65	315